

Hack Fab

Mini-T 2.0 Midget Car Cage



Hardware

2 - M2 x 12 Cap Head Screws

17 - M2.5 x 6 Button Head Screws

10 - M2.5 x 10 Button Head Screws

20 - M2.5 x 12 Button Head Screws



1

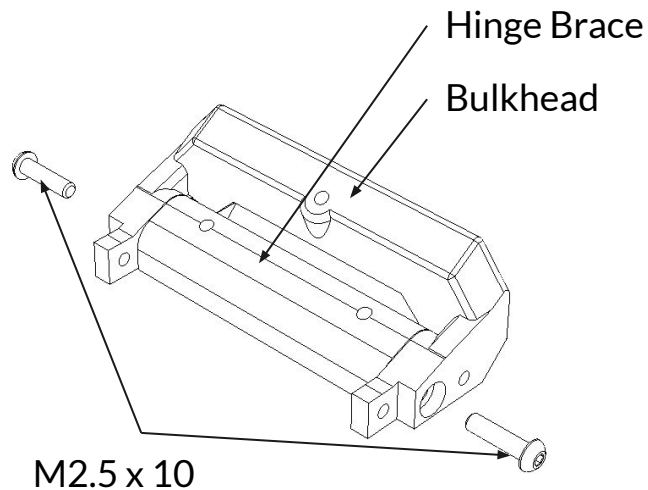

When inserting the screws into the Hinge, screw them in until they are just snug then back them off 1 turn to allow the hinge to move freely.

2

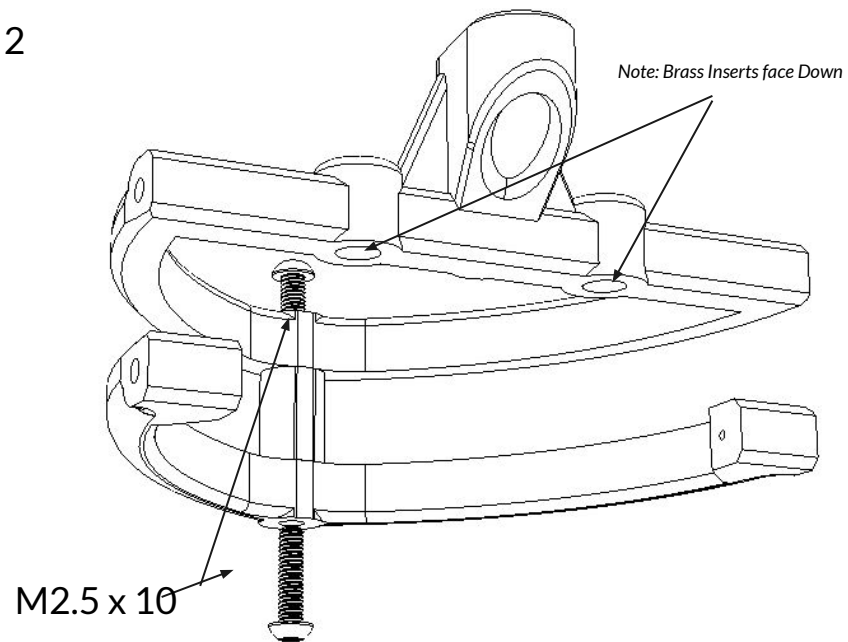

Use the supplied spacer and 2 - m2.5x10 BHS to assemble the tail tank cage. Make sure the brass inserts on the cage are facing down toward the lower cage.

3

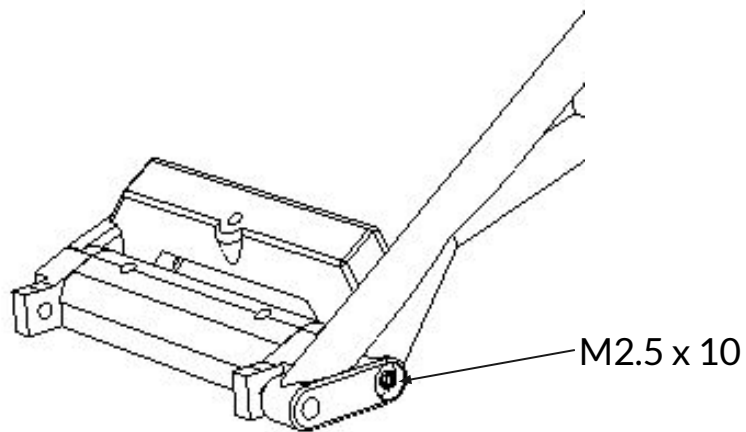

Attach the front bulkhead to the cage with 1 - M2.5x10.

4

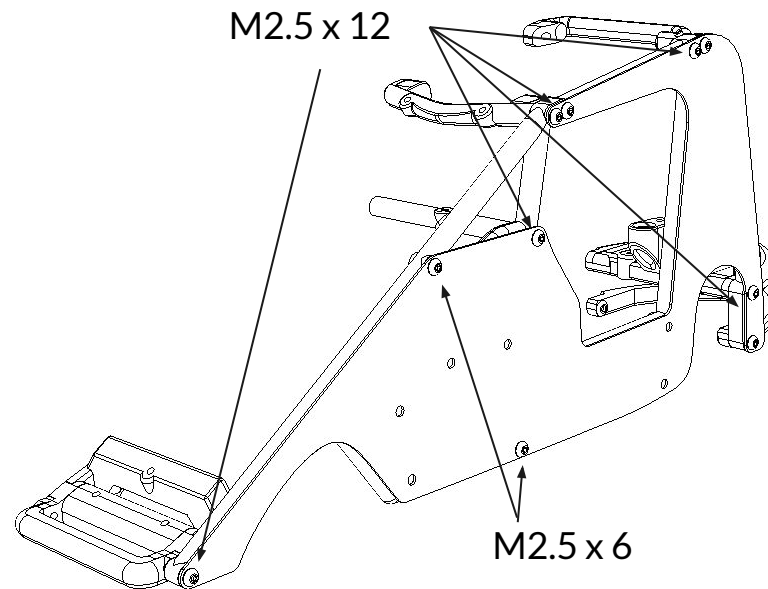

Attach the Body to the cage with 2 - 2.5x6mm. Then use the 8 - 2.5x12mm to secure the braces and flex bumper in place.

5

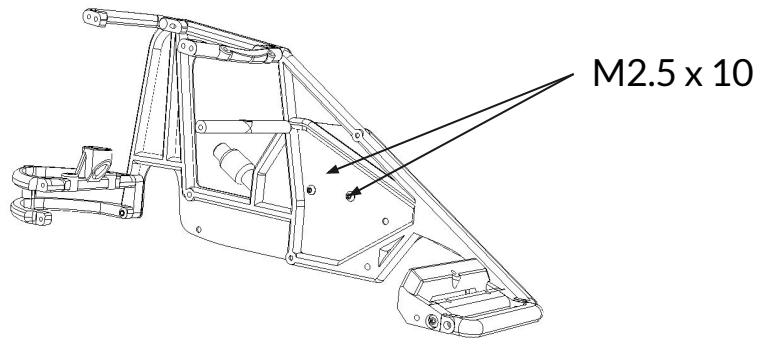
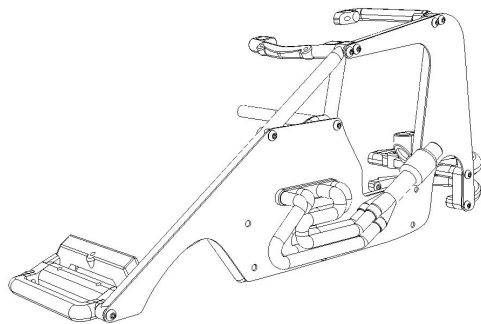

Use 2 - m2.5x10 to install the headers to the body panel side. Note: The left Body has two extra holes for the headers.

6

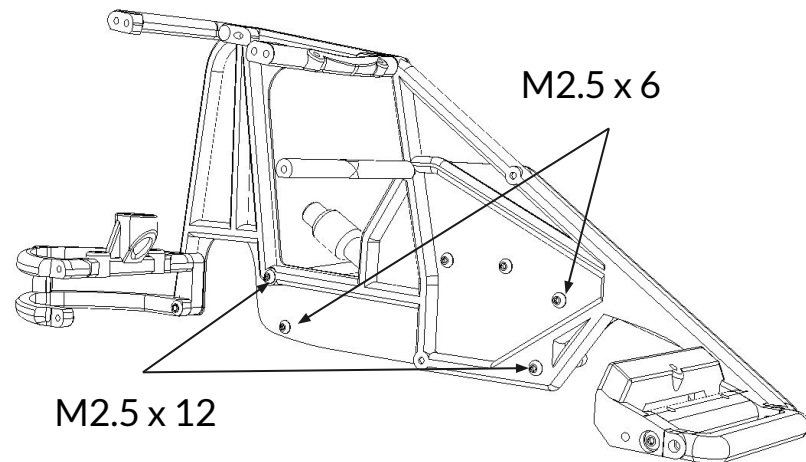
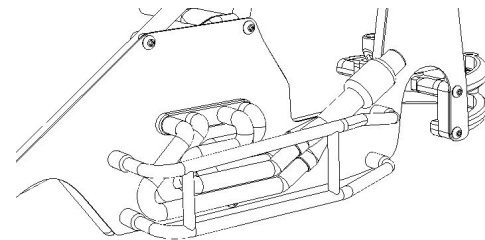

Use 2 - m2.5x12 and 2 - M2.5x6 to attach the Nerf Bar to the side of the body.

7

Before you attach the right side cage, attach the right side Nerf Bar to the body and cage.

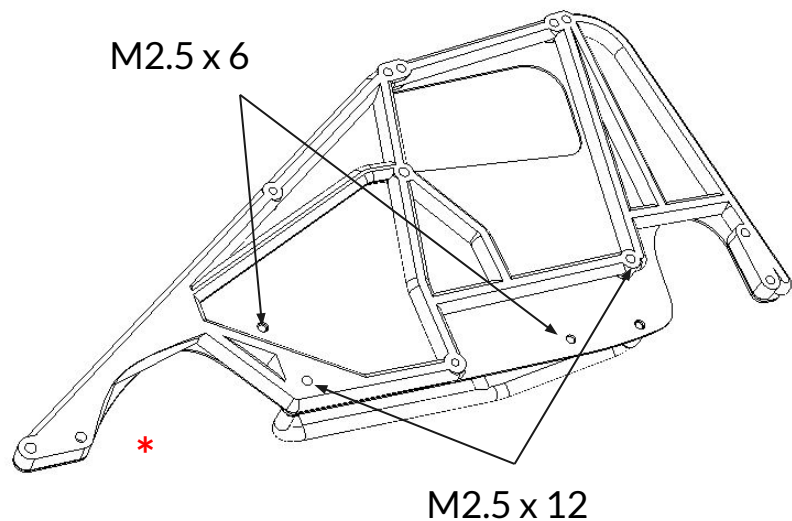

Use 2 - m2.5x12 and 2 - M2.5x6 to attach the Nerf Bar to the side of the body.

8

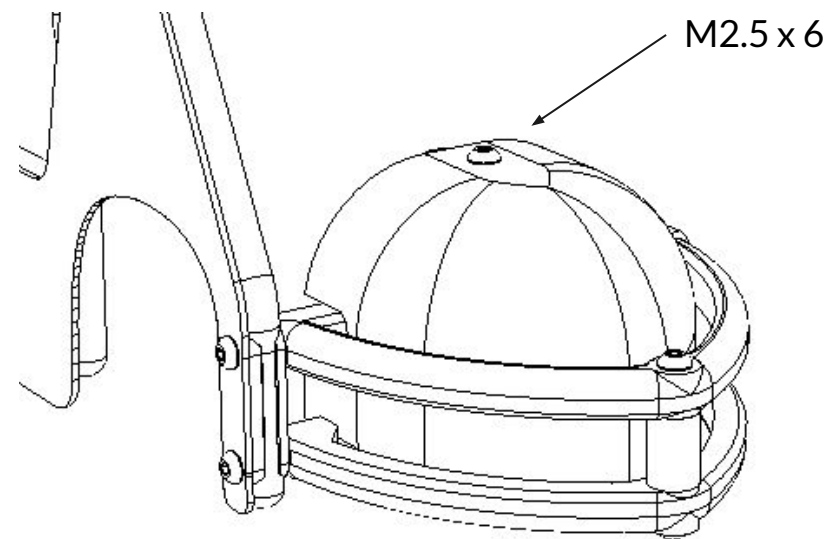

Attach the tail tank with the supplied 1 - m2.5x6 BHS. Insert the tail tank from the top with the recess around the cross brace. Then rotate the tail tank down into place.

9

Install the right side cage with the 8 - M2.5x12 and 2 - M2.5x6.

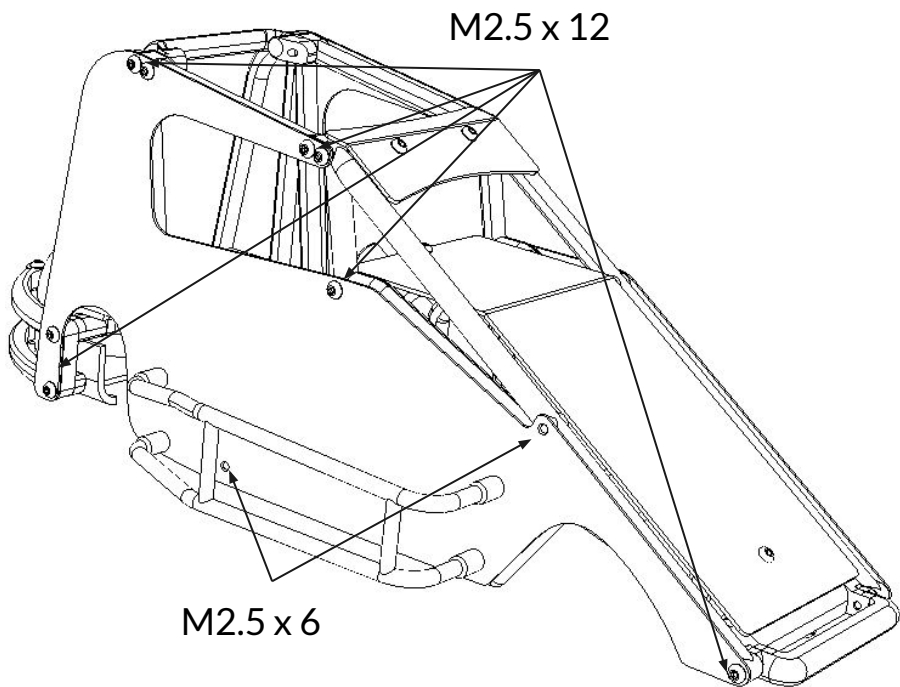

10

Use 4 - M2.5 x 6 to secure the Sun Visor and the Hood In place

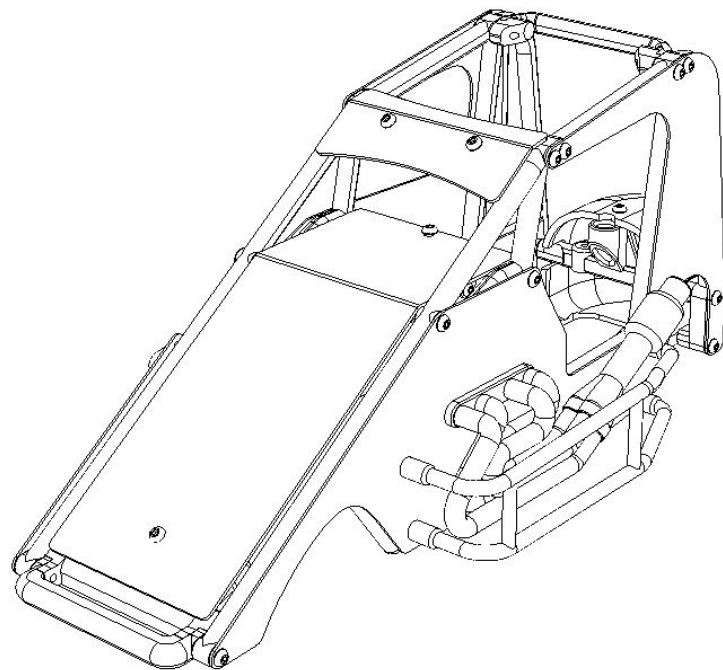

11 Front Tower Install

Use Supplied Spacers to stand the shock off the front & rear tower.

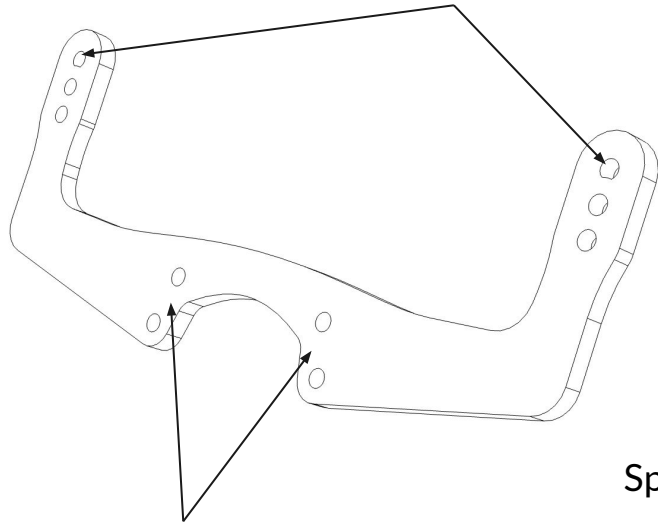

Use Stock Screws to Attach Tower to Front Bulkhead

Spacers

12 Rear Tower Install

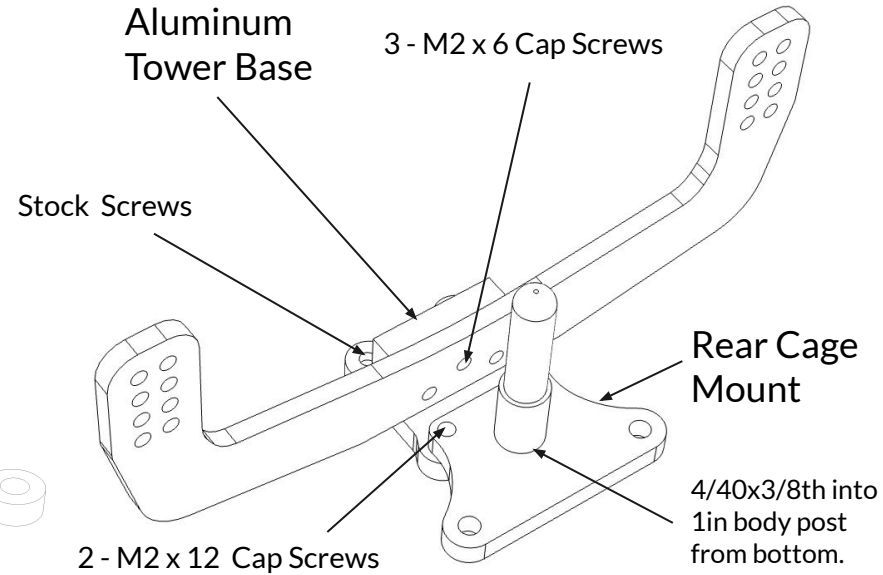

Use 3 - M2 x 6 Cap Screws to attach the tower to the rear Aluminum tower mount. To mount the Aluminum tower mount to the transmission, use the 2 - M2 x 12 through the rear cage mount.

13 Rear Tower Reference Photo

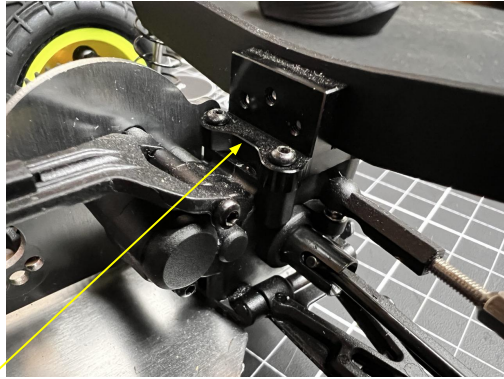

Aluminum
Tower Base

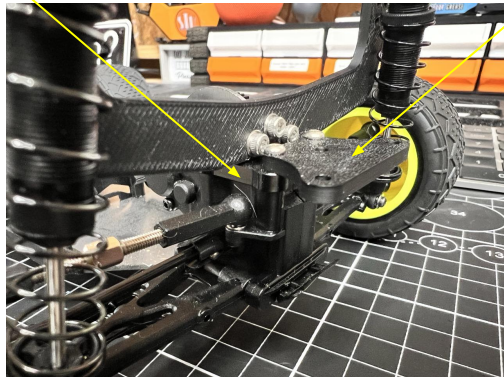

Rear Cage
Mount

14 Front Cage Mount Install



M2x12 Cap Screws Through the Mount Block into the front chassis Bulkhead

M2.5x6 Button Head Screws Through the Mount Block into the front bumper to hold the cage in place.

Use 2 - M2 x 12 Cap Screws to attach the front mounting block to the chassis in place of the factory skid and screws, use the 2 - M2.5 x through the mounting block into the cage bumper.

13

Trimming the Tail Tank

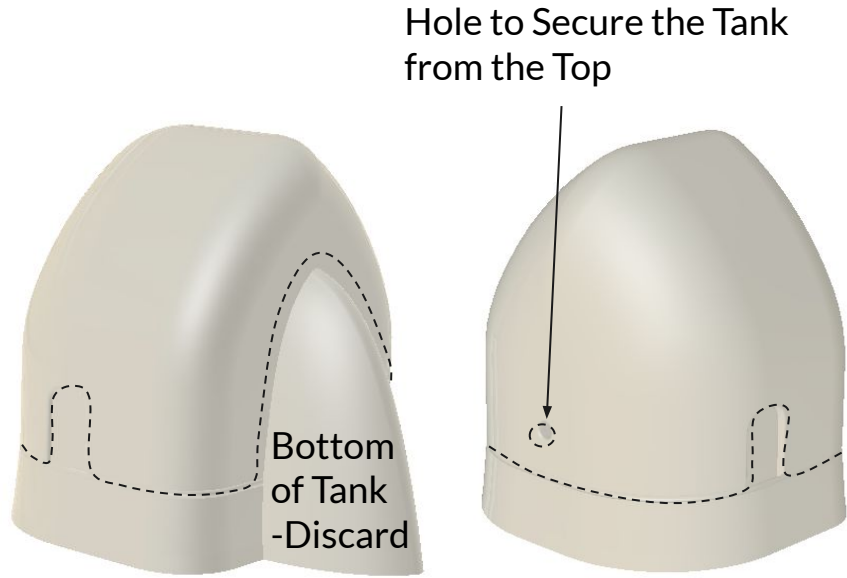

14

Hood Air Cleaner Installed with 2 - M2.5x6

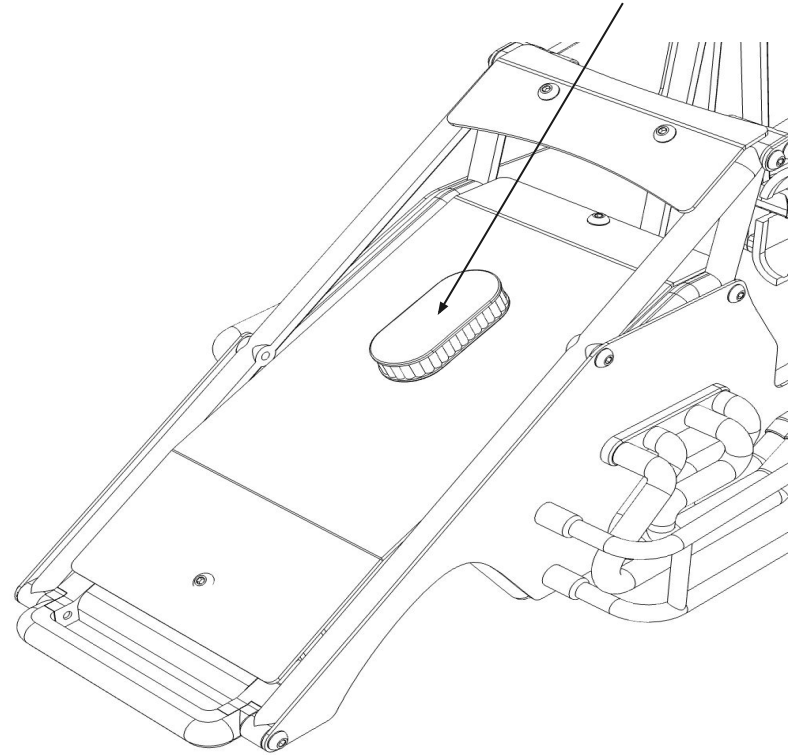

Additional Information

